



Operations Manual

Date: 03/31/05

Team 15 Members

Keith Brooks

Jordan Brooks

Dwayne Tillman

Ingrid Sarvis

Operations Manual

Carrier Mounting Instructions:

1. First insert the middle mainframe support (#1 diagram 3) into the receiver on the existing hitch (#2 diagram 2).
2. Line up the holes in the receiver and support and insert one of the supplied 5/8" diameter pins.
3. Measure the distance from the center of the receiver on the existing hitch to the center of the outside mainframe supports (#2 diagram 3) on both sides.
4. Next take the carrier out of the existing receiver.
5. Take one of the brackets (#4 diagram 1) and slide it over the cross-member of the existing hitch, as seen in diagram 2.
6. Slide the small C portion (#2 diagram 1) in from the back of the hitch making sure to keep the flat side against the cross-member of the hitch.
7. Line up the four holes and apply the supplied 1/2" bolts into each hole making sure not to tighten up the nuts so that the hitch will not slide across the cross-member of the hitch. Apply the bolts to where the nuts are to the inside of the C on both top and bottom as seen in Diagram 1.
8. Repeat steps 5-7 for applying the other hitch bracket.
9. Use the measurements taken in step 3 and place the brackets in the correct position.
10. After positioning the brackets tighten all bolts down snug to where the brackets cannot slide.
11. Take the carrier and slide the ends of the mainframe supports into the receivers of the existing hitch and brackets.
12. Insert the three 5/8" pins through the holes in the supports and receivers. Then apply supplied cotter keys into the pins.
13. Plug in the trailer lights.
14. The carrier is now applied to the vehicle and ready for use.

Loading and Unloading Instructions:

1. First use the above instructions for mounting the carrier to the vehicle safely.
2. Next take the pins out that hold in the ramps onto the carrier (#2 diagram 4).
3. Take one of the ramps out and slide the channel end of the ramp (#2 diagram 5) over the round bar (#1 diagram 5) that is attached to the end of the carrier that you wish to load your ATV. Repeat this process for attaching the other ramp.
4. Open the door on the end that you wish to load your ATV. Do not open the other door so that you know how far to pull the ATV onto the carrier.
5. Pull the ATV onto the carrier paying attention to making sure the ATV stays centered on the carrier and does not drive over the slots for the ramps.
6. Once the ATV is on the carrier close and latch the door.
7. Place the ramps back into the slots and put back the four pins that hold the ramps into place.
8. It is recommended that the ATV is strapped down to the carrier for travel.
9. The ATV is now ready for travel.
10. To unload the ATV just repeat the prior steps except for unloading not loading.

Warnings!

1. Do not apply more than 1000 lbs load onto the carrier. Do not forget to include the weight of the person who is loading or unloading the vehicle or any other items that may be carried on the ATV.
2. Do not overload the hitch that the carrier is attaching too. If the hitch has a 1000 lbs tongue weight limit do not go over this limit, not forgetting to include the weight of the carrier (180 lbs).

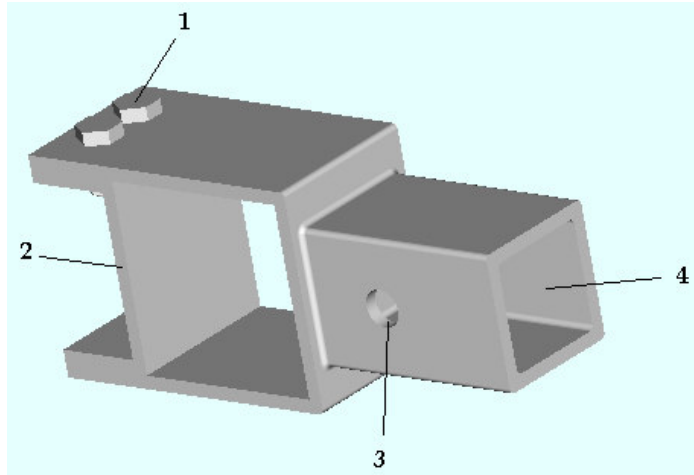

Diagram 1 Bracket that attach to existing hitch

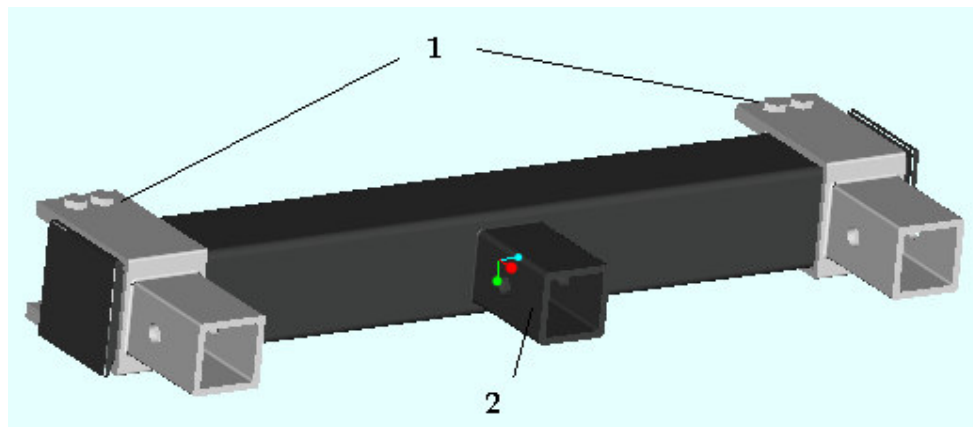

Diagram 2 Brackets attached to existing hitch

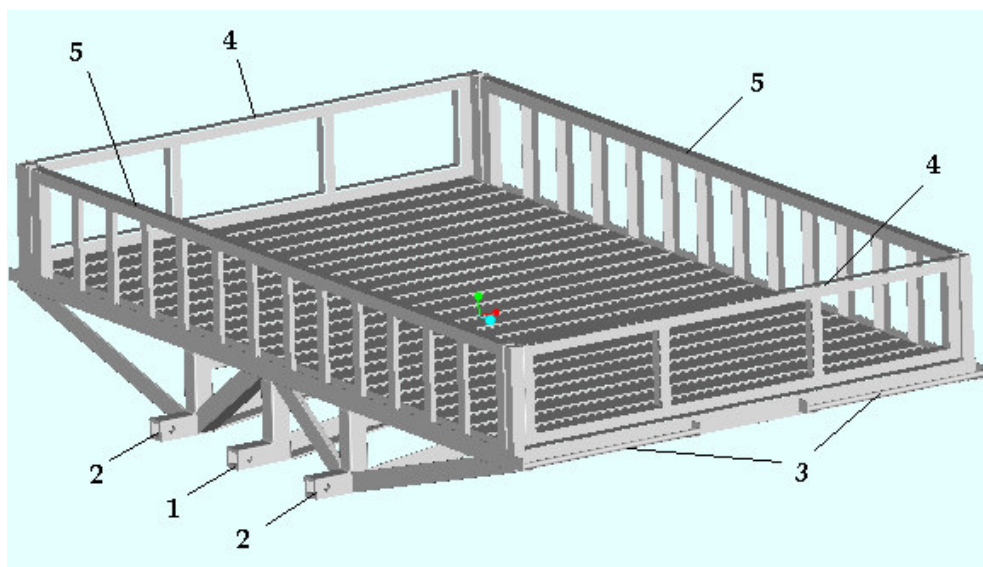

Diagram 3 ATV carrier

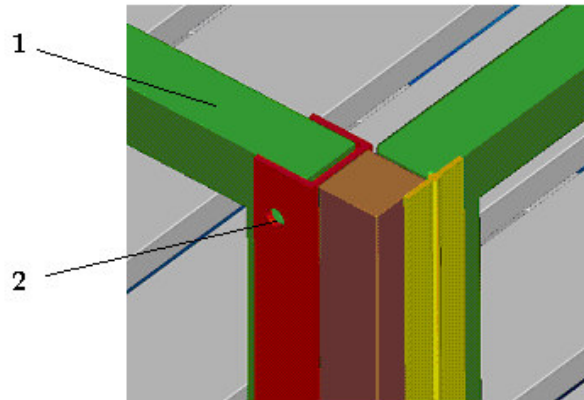

Diagram 4 Close-up of corner post

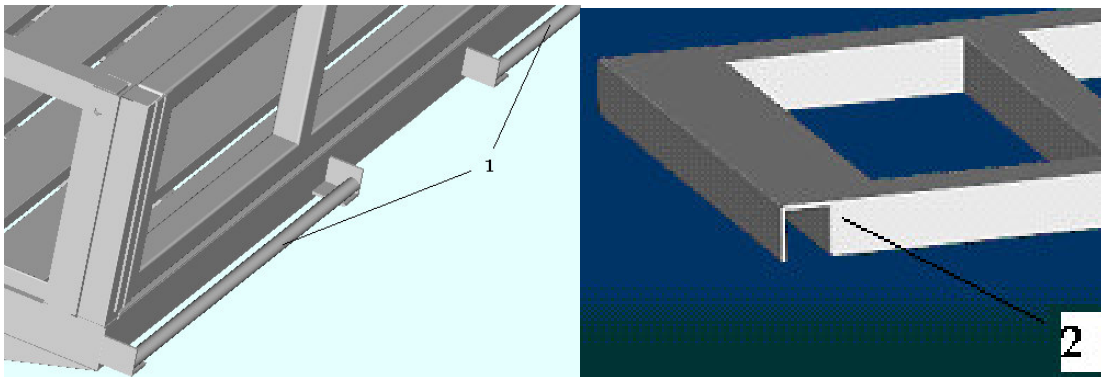

Diagram 5 Ramp and ramp attachment to carrier